

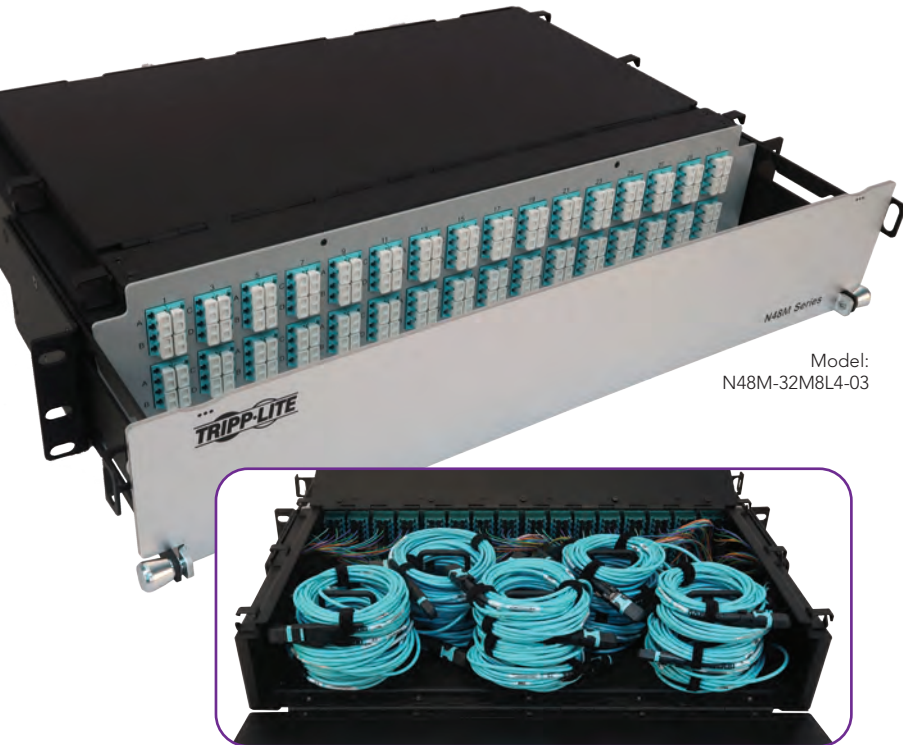

Powering and Connecting Your World

Preloaded Slack-Free Fiber Panels and Patch Panels

All-in-One Cabling Solutions Simplify Fiber Optic Installations



Model:
N48M-32M8L4-03

Panels are preloaded with fiber optic cable to give installers the flexibility to adjust cable lengths as needed.

Perfect for:

Fiber installations in data centers, labs and colocation facilities.

Tripp Lite's preloaded fiber cable solutions mount in standard 19-inch racks to provide port-to-port connections between rack equipment, such as servers and switches, without cable slack. Each panel contains coils of premium-quality fiber cable; installers extend the length they need and the remainder of the cable stays in the panel. 2U and 3U models are patch panels with LC duplex ports.

The panels simplify the installation of fiber optic networks. With a single purchase, installers have the fiber cables they need without the time-consuming tasks of predetermining equipment placement, measuring distances and ordering custom-length cables.

Key Benefits

TIME-SAVING CONVENIENCE

- Preloaded singlemode or multimode fiber cables eliminate the complexity and long wait times of custom-length cable orders.
- Delays associated with missing, backordered or incorrectly sized cables are avoided.

SIMPLIFIED INSTALLATIONS

- Panels mount in standard 19-inch server racks and open for easy access.
- Since cable lengths are adjustable, the exact placement of equipment does not need to be predetermined.
- Cables are labeled with length in meters; panel cover has writing space for port labeling.

REDUCED CABLE CLUTTER

- The ability to customize cable length eliminates slack for a neater, more organized installation.
- Slack-free cables make equipment maintenance and replacement easier.
- Less cable clutter promotes better airflow through the rack.

COST EFFECTIVENESS

- Flexibility in cable length allows equipment moves without the purchase of new cables in different lengths.

Feature Focus

1U Preloaded Fiber Panels

Model: N48S-2M8L4-20

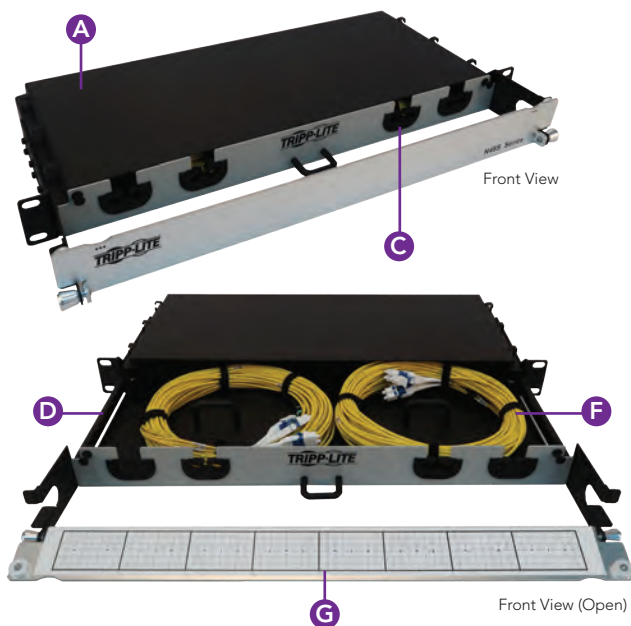

2U and 3U Preloaded Fiber Patch Panels

Model: N48M-32M8L4-03

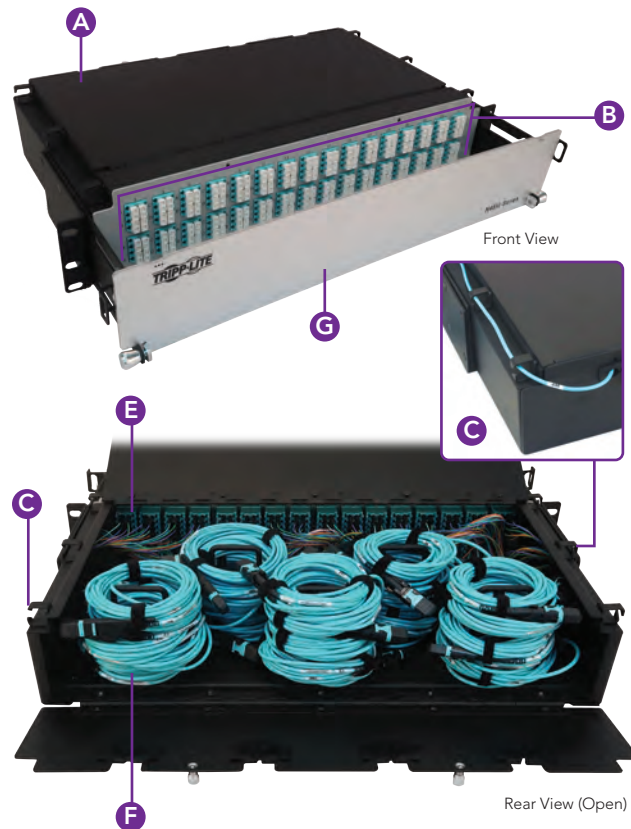

A Rack-Mount Aluminum Chassis

1U, 2U or 3U panel mounts in an enclosure or open frame rack.

B LC Duplex Ports (2U and 3U models)

Ports are protected by the fold-down cover.

C Optional Cable Routing

1U panels have front-to-rear cable routing. 2U and 3U patch panels have rear-to-front cable routing.

D Sliding Cable Tray (1U models)

Tray tilts down for easy cable access.

E Cable Compartment (2U and 3U models)

Top panel lifts up and rear plate flips down for cable access.

F Preloaded Cables

Labels indicate length in meters. Hook-and-loop straps keep coils neat.

G Fold-Down Cover

Writing space supports port labeling.

SPECIFICATIONS

1U PRELOADED FIBER PANELS

Model	Description
SINGLEMODE	
N48S-8L2L-10	1U, 8x (LC/LC Duplex Cables M/M), OS2, 10 m (32.8 ft.)
N48S-6L8L-10	1U, 6x (4x LC/LC Duplex M/M) 8F Trunk Cables, OS2, 10 m (32.8 ft.)
N48S-4L16L-10	1U, 4x (8x LC/LC Duplex M/M) 16F Trunk Cables, OS2, 10 m (32.8 ft.)
N48S-2L24L-10	1U, 2x (12x LC/LC Duplex M/M) 24F Trunk Cables, OS2, 10 m (32.8 ft.)
N48S-2L24L-20	1U, 2x (12x LC/LC Duplex M/M) 24F Trunk Cables, OS2, 20 m (65.6 ft.)
N48S-4M3X8M-10	1U, 4x (3x8F MTP/MPO-APC F/F) 24F Trunk Cables, OS2, 10 m (32.8 ft.)
N48S-2M3X8M-20	1U, 2x (3x8F MTP/MPO-APC F/F) 24F Trunk Cables, OS2, 20 m (65.6 ft.)
N48S-4M8L4-10	1U, 4x (12F MTP/MPO-APC to 4x LC Duplex F/M) 8F Trunk Cables, OS2, 10 m (32.8 ft.)
N48S-2M8L4-20	1U, 2x (12F MTP/MPO-APC to 4x LC Duplex F/M) 8F Trunk Cables, OS2, 20 m (65.6 ft.)
N48S-2M24L12-10	1U, 2x (24F MTP/MPO-APC to 12x LC Duplex F/M) 24F Trunk Cables, OS2, 10 m (32.8 ft.)
N48S-2M24L12-20	1U, 2x (24F MTP/MPO-APC to 12x LC Duplex F/M) 24F Trunk Cables, OS2, 20 m (65.6 ft.)

Model	Description
MULTIMODE	
N48M-8L2L-10	1U, 8x (LC/LC Duplex Cables M/M), OM4, 10 m (32.8 ft.)
N48M-6L8L-10	1U, 6x (4x LC/LC Duplex M/M) 8F Trunk Cables, OM4, 10 m (32.8 ft.)
N48M-4L16L-10	1U, 4x (8x LC/LC Duplex M/M) 16F Trunk Cables, OM4, 10 m (32.8 ft.)
N48M-2L24L-10	1U, 2x (12x LC/LC Duplex M/M) 24F Trunk Cables, OM4, 10 m (32.8 ft.)
N48M-2L24L-20	1U, 2x (12x LC/LC Duplex M/M) 24F Trunk Cables, OM4, 20 m (65.6 ft.)
N48M-4M3X8M-10	1U, 4x (3x8F MTP/MPO-PC F/F) 24F Trunk Cables, OM4, 10 m (32.8 ft.)
N48M-2M3X8M-20	1U, 2x (3x8F MTP/MPO-PC F/F) 24F Trunk Cables, OM4, 20 m (65.6 ft.)
N48M-4M8L4-10	1U, 4x (12F MTP/MPO-PC to 4x LC Duplex F/M) 8F Trunk Cables, OM4, 10 m (32.8 ft.)
N48M-2M8L4-20	1U, 2x (12F MTP/MPO-PC to 4x LC Duplex F/M) 8F Trunk Cables, OM4, 20 m (65.6 ft.)
N48M-2M24L12-10	1U, 2x (24F MTP/MPO-PC to 12x LC Duplex F/M) 24F Trunk Cables, OM4, 10 m (32.8 ft.)
N48M-2M24L12-20	1U, 2x (24F MTP/MPO-PC to 12x LC Duplex F/M) 24F Trunk Cables, OM4, 20 m (65.6 ft.)

2U & 3U PRELOADED FIBER PATCH PANELS

Model	Description
SINGLEMODE	
N48S-32M8L4-03	2U, 32x (12F MTP/MPO-APC to 4x LC Duplex F/F) 8F Trunk Cables, OS2, 3 m (9.8 ft.)
N48S-64M8L4-03	3U, 64x (12F MTP/MPO-APC to 4x LC Duplex F/F) 8F Trunk Cables, OS2, 3 m (9.8 ft.)
N48S-48M8L4-05	3U, 48x (12F MTP/MPO-APC to 4x LC Duplex F/F) 8F Trunk Cables, OS2, 5 m (16.4 ft.)
N48S-24M8L4-10	3U, 24x (12F MTP/MPO-APC to 4x LC Duplex F/F) 8F Trunk Cables, OS2, 10 m (32.8 ft.)
MULTIMODE	
N48M-32M8L4-03	2U, 32x (12F MTP/MPO-PC to 4x LC Duplex F/F) 8F Trunk Cables, OM4, 3 m (9.8 ft.)
N48M-64M8L4-03	3U, 64x (12F MTP/MPO-PC to 4x LC Duplex F/F) 8F Trunk Cables, OM4, 3 m (9.8 ft.)
N48M-48M8L4-05	3U, 48x (12F MTP/MPO-PC to 4x LC Duplex F/F) 8F Trunk Cables, OM4, 5 m (16.4 ft.)
N48M-24M8L4-10	3U, 24x (12F MTP/MPO-PC to 4x LC Duplex F/F) 8F Trunk Cables, OM4, 10 m (32.8 ft.)

Learn more about Tripp Lite's full line of fiber solutions at triplite.com.

© 2021 Tripp Lite. All trademarks are the property of their respective owners. Tripp Lite has a policy of continuous improvement. Specifications are subject to change without notice. Photos and illustrations may differ slightly from actual products.



Manufacturing Excellence.



Tripp Lite Corporate Headquarters

1111 West 35th Street, Chicago, IL 60609 USA | 773.869.1773 | triplite.com